

CORNER RECORD

Document Number CR 6251
County of ALAMEDA, California

City of BERKELEY
Brief Legal Description CITY OF BERKELEY MONUMENT B2896

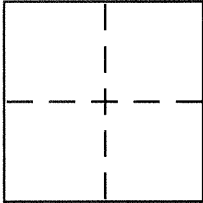

CORNER TYPE

Government Corner ☐ Control ☒
Meander ☐ Property ☐
Rancho ☐ Other ☐
Date of Survey APRIL 16, 2014

COORDINATES (Optional)

N. _____
E. _____
Zone _____ NAD27 ☐ NAD83 ☐
NAD83 Epoch _____
Elev. _____
Vert. Datum: NGVD29 ☐ NAVD88 ☐
Meas. Units: Metric ☐ Imperial ☐

Corner – Left as found ☒ Found and tagged ☐ Established ☐ Reestablished ☐ Rebuilt ☐

Identification and type of corner found: Evidence used to identify or procedure used to establish or reestablish the corner:
**IN COMPLIANCE WITH SECTION 8771 OF THE PROFESSIONAL LAND SURVEYORS' ACT, THIS CORNER
RECORD IS BEING FILED TO ESTABLISH THE POSITION OF AN EXISTING MONUMENT PRIOR TO STREET
RECONSTRUCTION. (SEE PAGE 2)**

A description of the physical condition of the monument as found and as set or reset:
CITY OF BERKELEY STANDARD WELL-TYPE MONUMENT, FOUND IN GOOD CONDITION. (SEE PAGE 2)

SURVEYOR'S STATEMENT

This Corner Record was prepared by me or under my direction in conformance with
the Land Surveyors Act on APRIL 29, 2014
Signed [Signature] P.L.S. or R.C.E. No. 5003

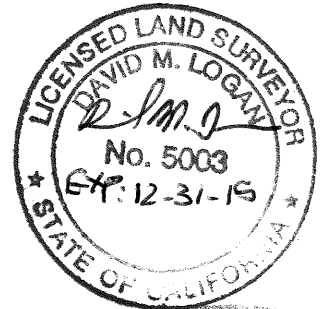

COUNTY SURVEYOR'S STATEMENT

This Corner Record was received 5-20-2014
and examined and filed 6-16-2014
Signed [Signature] P.L.S. or R.C.E. No. 5726
Title COUNTY SURVEYOR

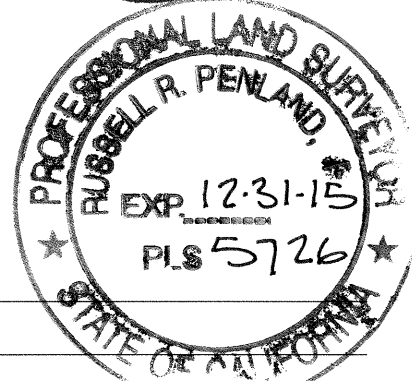

County Surveyor's Comment _____

G046E3

RP-4
EL=259.47'

RP-1
EL=259.56'

70°48'44"

#621

25.92'

27.13'

109°11'16"

B2896
EL=257.70'

109°11'16"

21.72'

42.48'

70°48'44"

RP-3
EL=256.85'

SANTA ROSA
AVENUE

#627

RP-2
EL=255.32'

LEGEND



3/4" IRON PIN CITY MONUMENT IN
A STANDARD MONUMENT WELL



SET REFERENCE CROSS

NOTE:

THE EXISTING MONUMENT AS SHOWN IS
REFERENCED BY STRAIGHT LINES BETWEEN
RP-1 TO RP-3 AND RP-2 TO RP-4.



SCALE 1"=10'