

RECORD of SURVEY

for

CIRO L. TOMA and KIMBERLY A. TOMA, Trustees of the
Ciro L. Toma and Kimberly A. Toma Family Trust - 2007
20140000639

BEING A PORTION OF THE SW 1/4 SECTION 15, T. 7 N., R. 13 E., M. D. M.
COUNTY OF AMADOR, STATE OF CALIFORNIA

Scale: 1"=30'

Toma & Associates Inc.
ENGINEERING - SURVEYING - PLANNING
41 Summit Street, Jackson, CA 95642
(209) 223-0156

June, 2018

SURVEYOR'S STATEMENT

THIS MAP CORRECTLY REPRESENTS A SURVEY MADE BY ME OR UNDER MY DIRECTION IN CONFORMANCE WITH THE REQUIREMENTS OF THE PROFESSIONAL LAND SURVEYORS ACT AT THE REQUEST OF CIRO TOMA IN JUNE OF 2018.

DATE: JUNE 19, 2018

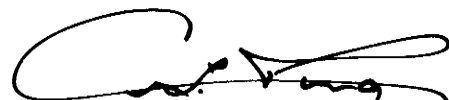

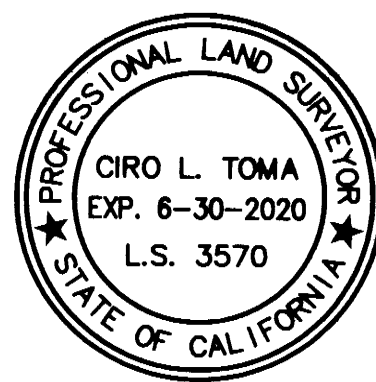
CIRO L. TOMA P.L.S. 3570
MY LICENSE EXPIRES 6-30-2020



COUNTY SURVEYOR'S STATEMENT

THIS MAP HAS BEEN EXAMINED IN ACCORDANCE WITH SECTION 8766 OF THE PROFESSIONAL LAND SURVEYORS ACT THIS 22nd DAY OF June 2018.
EXEMPT FROM SUBDIVISION MAP ACT [66428(a)(2)]

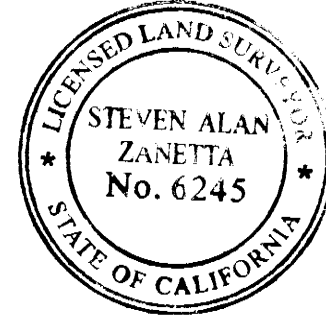
STEVEN A. ZANETTA PLS 6245
AMADOR COUNTY SURVEYOR
MY LICENSE EXPIRES 3-31-2020





RECORDER'S STATEMENT

FILED THIS 3rd DAY OF July 2018 AT 4:02 P.M.
IN BOOK 65 OF MAPS AND PLATS AT PAGE 72 AT THE REQUEST OF
THE AMADOR COUNTY SURVEYOR.

FEE: \$10⁰⁰ pd/filed

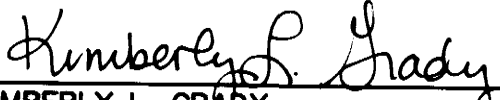
INSTRUMENT No.: 2018-0004919

KIMBERLY L. GRADY
AMADOR COUNTY RECORDER

BY: 
DEPUTY

NOTES and LEGEND

- DENOTES 3/4" REBAR WITH PLASTIC CAP STAMPED PLS 3570 SET ON THIS SURVEY
- DENOTES FOUND 3/4" REBAR WITH PLASTIC CAP STAMPED PLS 3570 PER 8-SUBS-21
- DENOTES FOUND 3/4" REBAR TAGGED LS 2902 PER 2-SUBS-52
- DENOTES FOUND 3/4" STEEL ROD TAGGED LS 2902 PER 8-SUBS-21
- DENOTES A CALCULATED POINT ONLY, NOTHING FOUND OR SET
- (1) DENOTES RECORD DATA PER 8-SUBS-21
- (2) DENOTES RECORD DATA PER 41-M-25
- (3) DENOTES RECORD DATA PER 2-SUBS-52

BASIS OF BEARINGS IS REFERRED TO A TIE BETWEEN FOUND MONUMENTS AS SHOWN ON 8-SUBS-21, THE BEARING OF WHICH IS N 88°51'40" W.

