

BLOCK 4
LOT 37
TRACT 833
14 M 4

NORTH SIXTH STREET
50' R/W
129.05

BLOCK 5
TRACT 803
20 M 55
LOT 2

PARCEL A
6,183 ± Square feet

PARCEL B
Net=9,911 ± Square feet
Gross=11,037 ± Square feet

Dedicated to the County of Alameda 89-015669
1-19-89
N 87° 48' 05" W 91.21 (91.14 Deed)
County of Alameda, 51050R469 AB-58188
N 87° 48' 05" W 106.39 (106.32 Deed)

GROVE (LAUREL AVENUE) WAY 60' R/W

REDWOOD ROAD
N 0° 27' 50" W

OWNER'S CERTIFICATE

The undersigned hereby certifies that she is the owner of the land delineated and embraced within the exterior boundary lines of the herein embodied map entitled "PARCEL MAP NO. 4936, EDEN TOWNSHIP, ALAMEDA COUNTY, CALIFORNIA"; that she is the owner of said land by virtue of the Deed recorded May 23, 1960 in Reel 92 Image 535, Recorder's Series No. AR/60034, Records of Alameda County, California; that she consents to the preparation and filing of this map.

Dora L. Thormahlen
DORA L. THORMAHLEN

ACKNOWLEDGEMENT

STATE OF CALIFORNIA)
COUNTY OF ALAMEDA)

On this 1st day of October, 1988, before me, Harold Bryan Davis, a Notary Public in and for said state, personally appeared DORA L. THORMAHLEN, known to me, or proved to me on the basis of satisfactory evidence, to be the person whose name is subscribed to the within instrument and acknowledged to me that she executed the same.

IN WITNESS WHEREOF I have hereunto set my hand and the imprint of my official seal

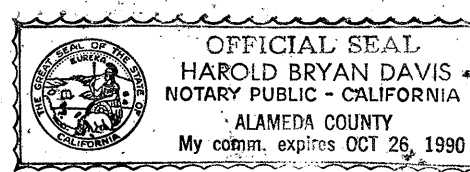

Harold Bryan Davis
NOTARY PUBLIC, State of California

CERTIFICATE OF CLERK, BOARD OF SUPERVISORS

I, William Mehrwein, Clerk of the Board of Supervisors of the County of Alameda, State of California, do hereby certify that certificates have been filed and deposits have been made in conformance with the requirements of Sections 66492 and 66493 of the Government Code of the State of California

Dated Jan. 23, 1989 WILLIAM MEHRWEIN
Clerk of the Board of Supervisors, County of Alameda, State of California
By Cindy R. Chard
Deputy

SURVEYOR'S CERTIFICATE

This map was prepared by me or under my direction and is based upon a field survey in conformance with the requirements of the Subdivision Map Act and Local Ordinance at the request of Dora L. Thormahlen in December, 1986. I hereby state that this parcel map substantially conforms to the approved or conditionally approved tentative map, if any. I hereby state that the monuments indicated hereon are of the character and occupy the positions indicated. I further state that the monuments are sufficient to enable the survey to be retraced.

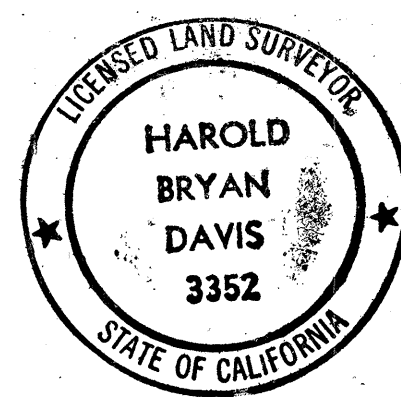

Harold B. Davis
HAROLD B. DAVIS
L.S. 3352
License expires 6/30/88

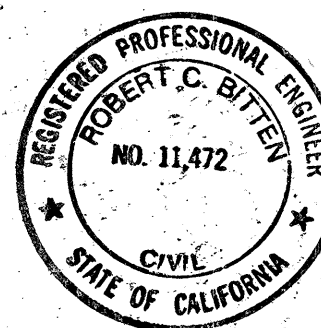

COUNTY SURVEYOR'S CERTIFICATE

This map conforms with the requirements of the Subdivision Map Act and Local Ordinance.

Dated 1-23-89
H. A. FLERTZHEIM, JR.
County Surveyor
R.C.E. No. 27615

By Robert C. Bitten
ROBERT C. BITTEN
Chief Deputy County Surveyor
R.C.E. No. 11472
Registration expires 12/31/88

PARCEL MAP NO. 4936
EDEN TOWNSHIP, ALAMEDA COUNTY,
CALIFORNIA

HAROLD B. DAVIS, L.S.
SAN LEANDRO, CALIFORNIA
DECEMBER, 1986
SCALE: 1" = 20'

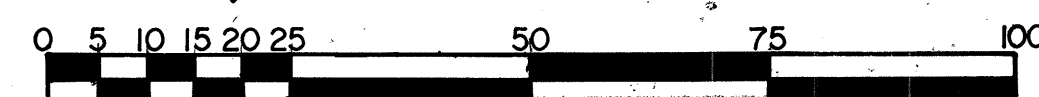

LEGEND

- = Standard Alameda County Concrete Monument, found
- = 1" Iron Pipe with Redwood plug, brass nail and tag LS3352, set.
- ⊙ = Railroad Spike, set
- = Exterior Boundary
- () = Record Data in discrepancy with field

BASIS OF BEARINGS

The monument line of Grove Way was taken to be N 87° 48' 05" W per Tract 803

COUNTY RECORDER'S CERTIFICATE

Filed this 24th day of January, 1989, at 9:07 A.M., in Book 182 of Parcel Maps at Page 17 at the request of Founders Title Company of Alameda County.
Fee: 6.00
Ser: 89-019283

RENE C. DAVIDSON
County Recorder

By Almes
Deputy County Recorder

