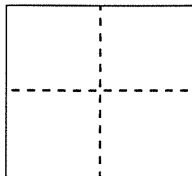

CORNER RECORD

Document Number

CR 6941City of Oakland (APN 48F-7383-32)County of Alameda, CaliforniaBrief Legal Description Monument in Thornhill Drive near 6100 Thornhill Drive**CORNER TYPE**

Government Corner ☐ Control ☒
 Meander ☐ Property ☐
 Rancho ☐ Other ☐

Date of Survey January 12, 2015**COORDINATES (Optional)**

N. _____
 E. _____
 Zone _____ NAD27 ☐ NAD83 ☐
 NAD83 Epoch _____
 Elev. _____
 Vert. Datum: NGVD29 ☐ NAVD88 ☐
 Meas. Units: Metric ☐ Imperial ☐

Pre-construction (waterline) Corner Record

Corner - Left as found ☒ Found and tagged ☐ Established ☐ Reestablished ☐ Rebuilt ☐

Identification and type of corner found: Evidence used to identify or procedure used to establish or reestablish the corner:

Found street monument that could be damaged or destroyed by planned water line construction project.

Monument was referenced as shown on page 2. The purpose of this Corner Record is to preserve possible evidence only; no attempt was made to determine the relationship to property, centerline, or right of way lines.

A description of the physical condition of the monument as found and as set or reset:

Monument was found in good condition and was referenced with four set reference points representing two intersecting lines as shown on Page 2.

Reference EBMUD Field Book 4472, Pages 60 (Clarke/Chou)

SURVEYOR'S STATEMENT

This Corner Record was prepared by me or under my direction in conformance with the Professional Land Surveyor's Act on January 22, 2015

Signed R. Lee Hixson P.L.S. or R.C.E. No. 4806

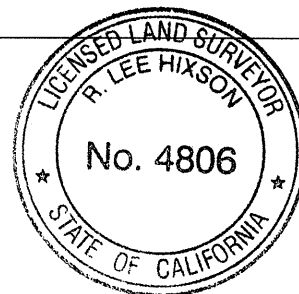
**COUNTY SURVEYOR'S STATEMENT**

This Corner Record was received 1-27-15
 and examined and filed 3-3-15

Signed Russell R. Penland P.L.S. or R.C.E. No. 5726

Title County Surveyor

County Surveyor's Comment: _____

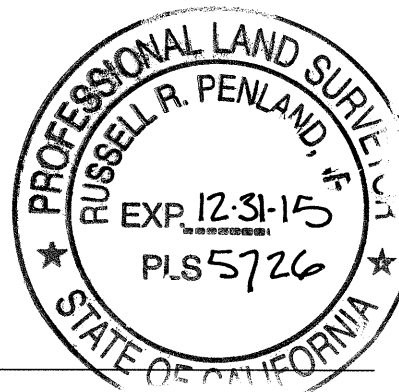
DZ13Z1

OAKLAND

ALAMEDA COUNTY

MERRIEWOOD
4 M 50
102

SCALE
1"=20'



THORNHILL DRIVE
(50' WIDE)

MERRIEWOOD DRIVE
(50' WIDE)

[104.45']
4.5' NE'LY FROM DI



64.03'

[100.00']

32.31'

23.14'

[105.08']
2.0' FROM EDGE AC
AT END STOP LINE



[101.39']
IN CONC PAD FOR ELECTROLIER

14 M 39
3
6100 THORNHILL DRIVE
APN 48F-7383-32

[100.40']
4.7' E'LY FROM EDGE AC,
20.3' N'LY FROM FENCE
CORNER

24 RS 76

THORNHILL CT.
(30' WIDE PRIVATE)



LEGEND



FOUND 1/4" PIN IN CONCRETE, 1.5' DOWN IN
STANDARD MONUMENT WELL, LID 0.3' BELOW
AC SURFACE ON C/L THORNHILL DRIVE; GOOD
CONDITION, PER 4 M 50



SET CONCRETE ANCHOR NAIL AND 1-1/2"
ALUMINUM WASHER, STAMPED "EBMUD MON RP"



SET MAG NAIL AND 1-1/2" ALUMINUM WASHER,
STAMPED "EBMUD MON RP" IN AC



ASSUMED ELEVATION (MEASURED USING A
LEICA DNA10 DIGITAL LEVEL)

ADDRESS: 6100 THORNHILL DRIVE
APN: 48F-7383-32

CR#

CR